

TVAM019

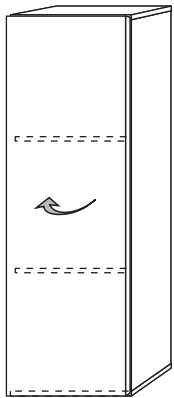

Typ:L



Typ:P

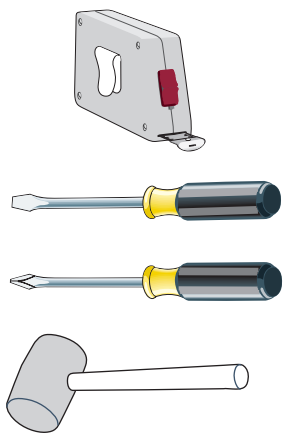
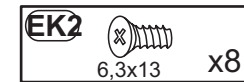
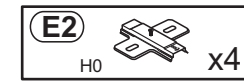
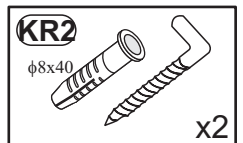
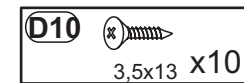
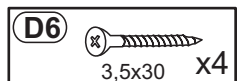
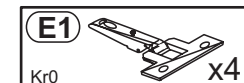
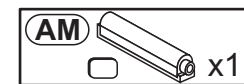
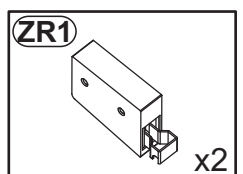
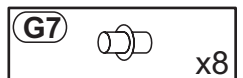
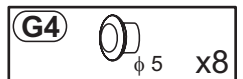
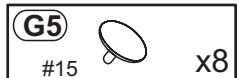
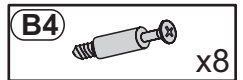
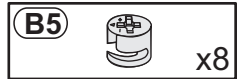
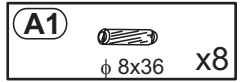
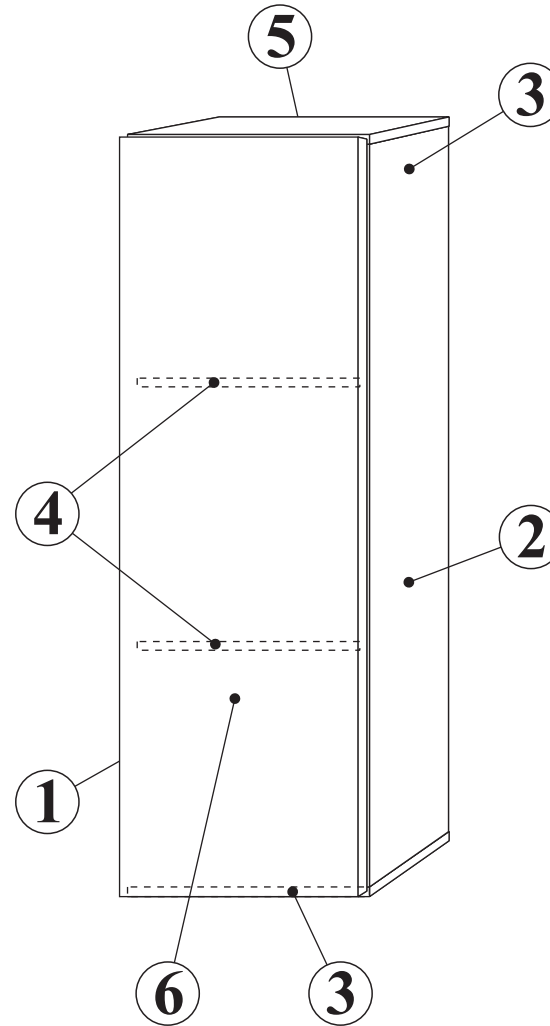
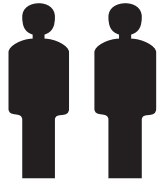
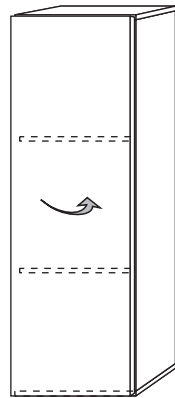

	15	18	22
0<400			
401<600	40	40	40
601<800	24		
801<1000	15	30	

1

Typ:L

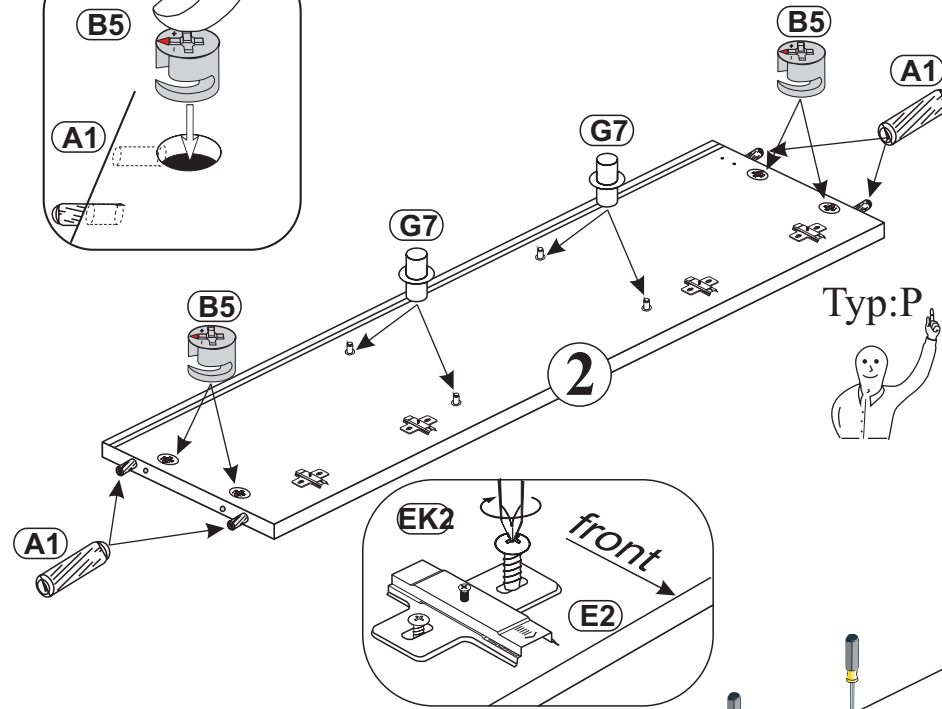
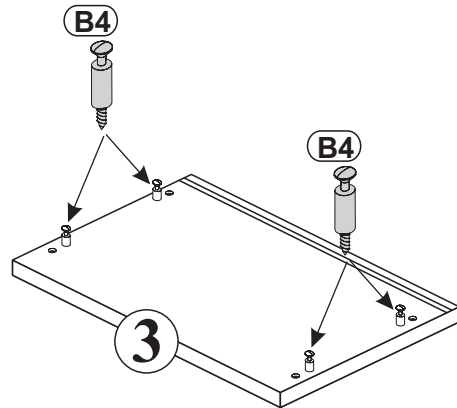
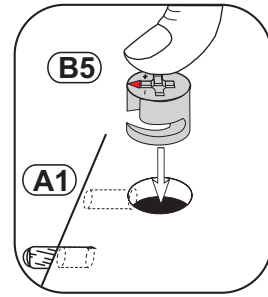
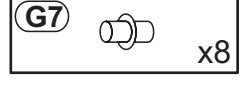
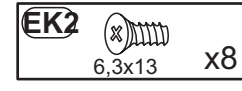
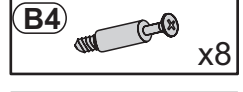
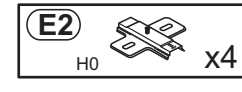
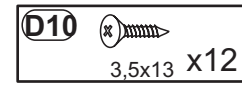
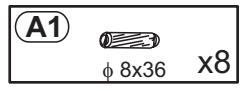
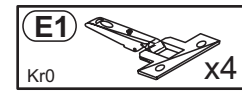
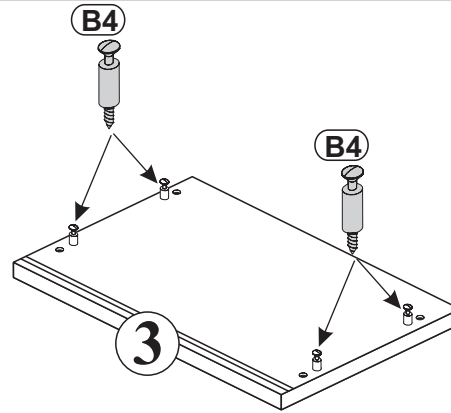
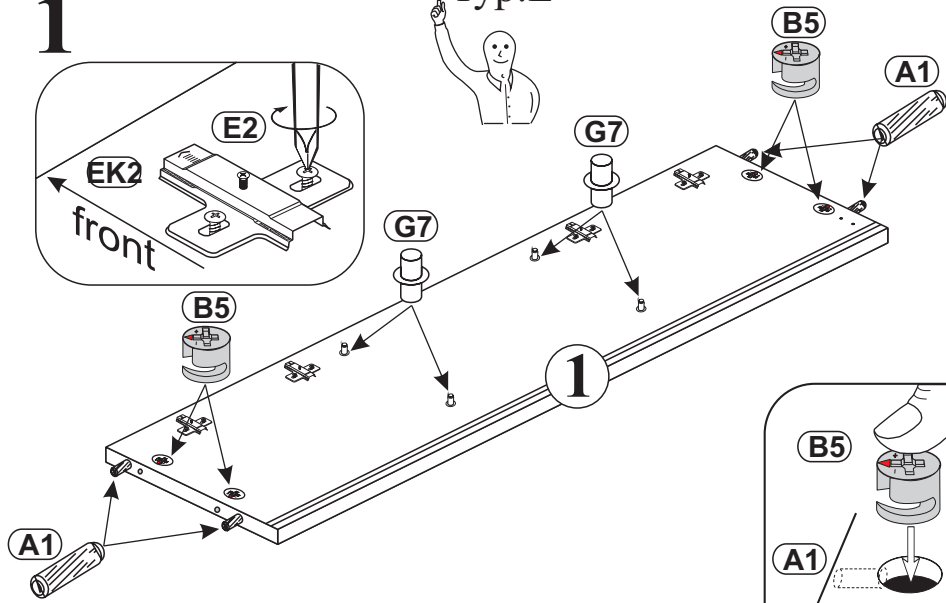
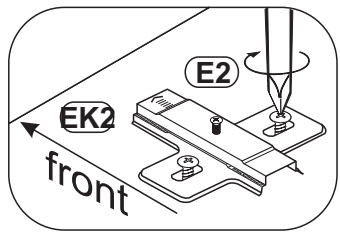

Typ:P

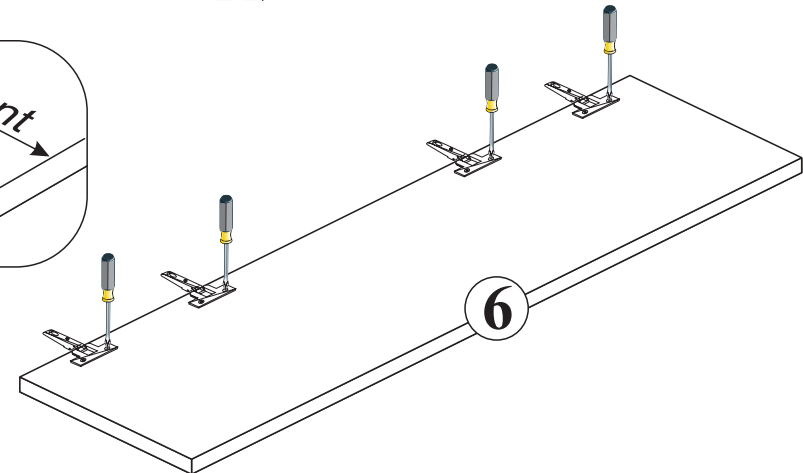
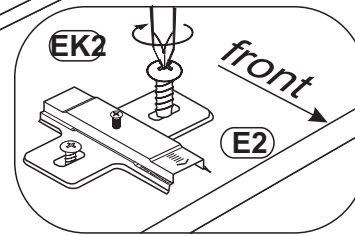
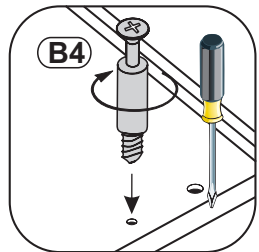
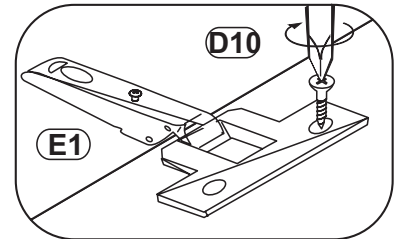

2

Typ:L



Typ:P

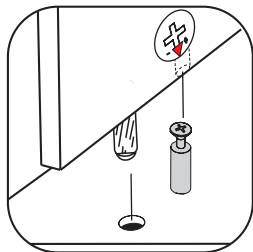
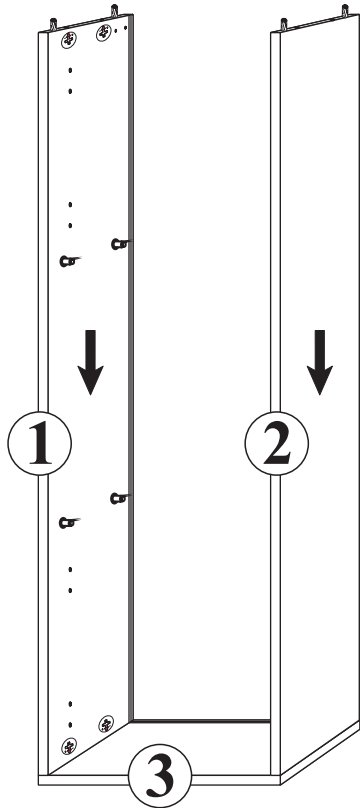
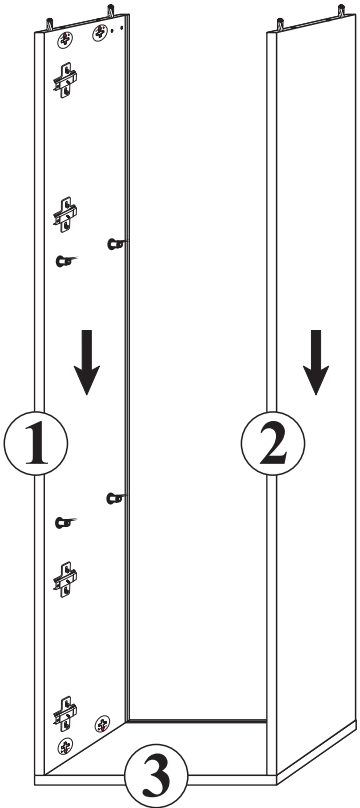

3

Typ:L



Typ:P

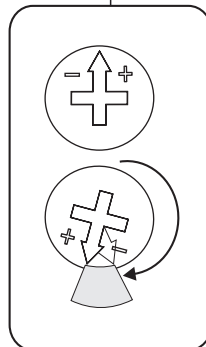
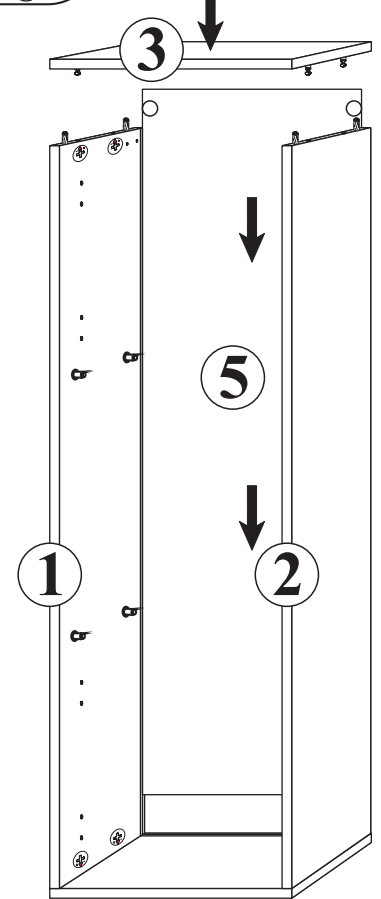
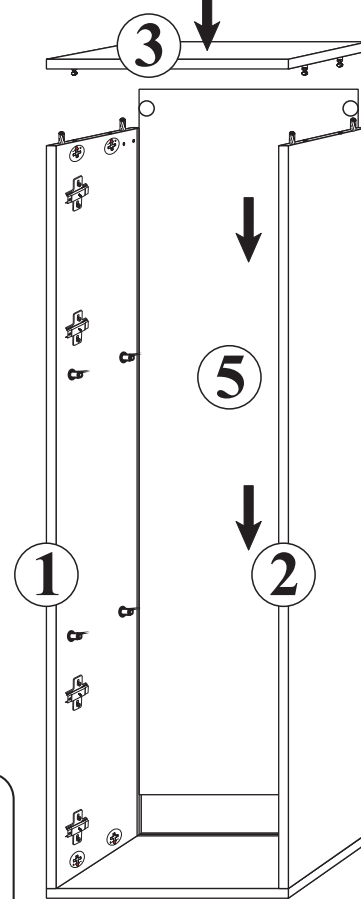
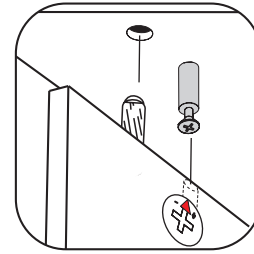

4



a=b

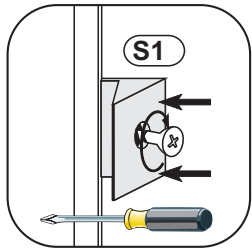
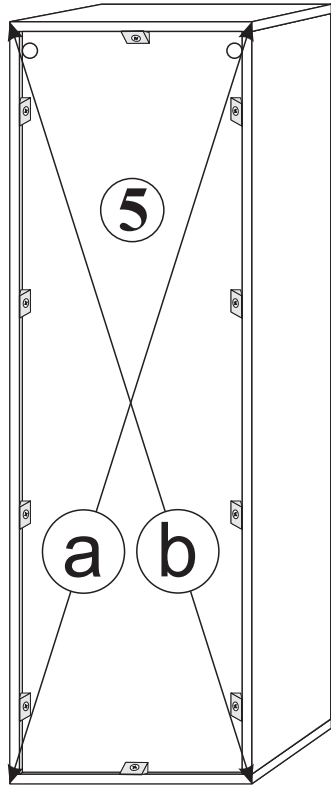

5

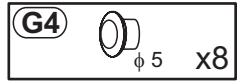
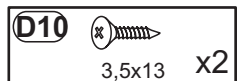
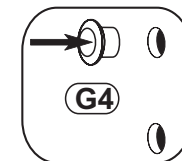
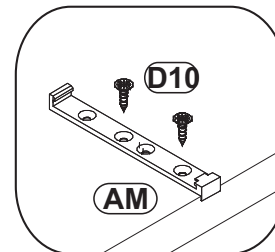
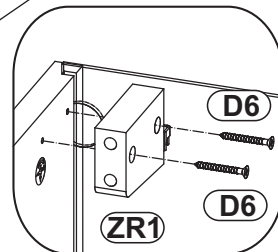
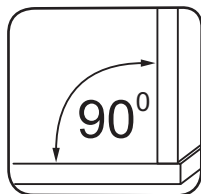
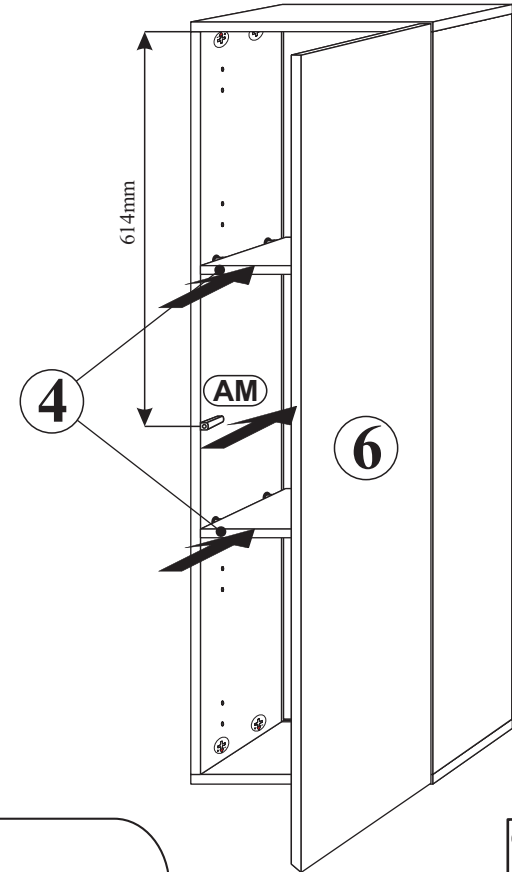
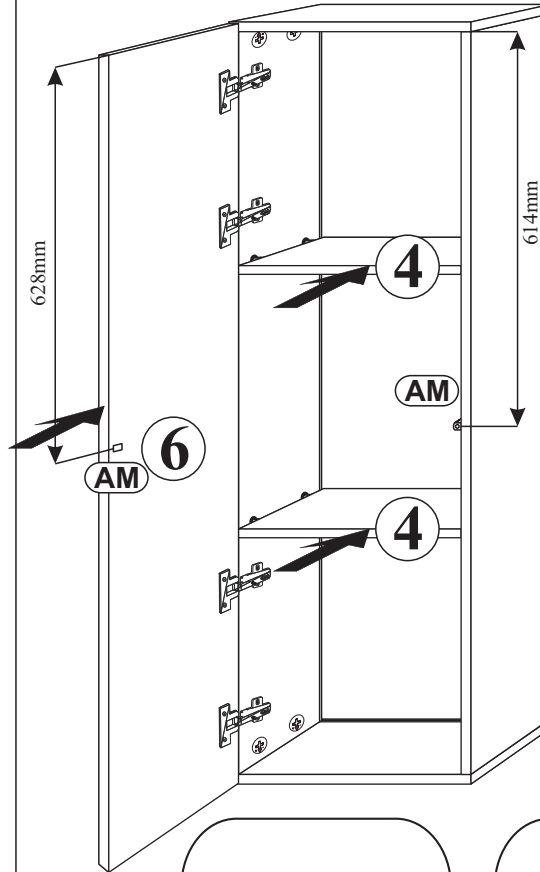
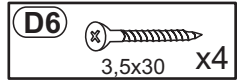
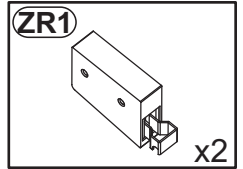
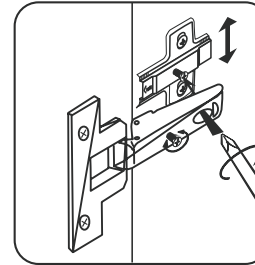
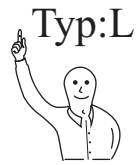

6

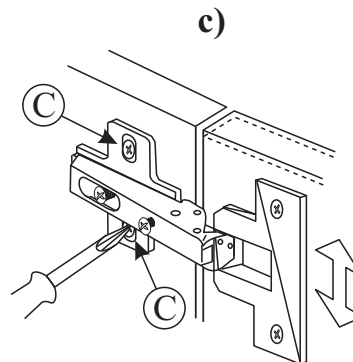
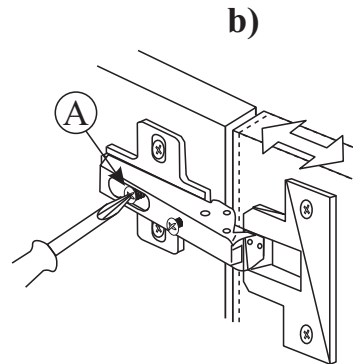
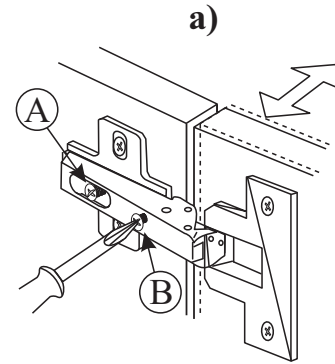
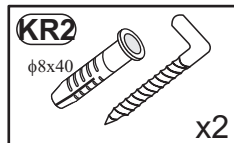
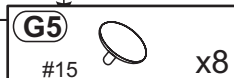
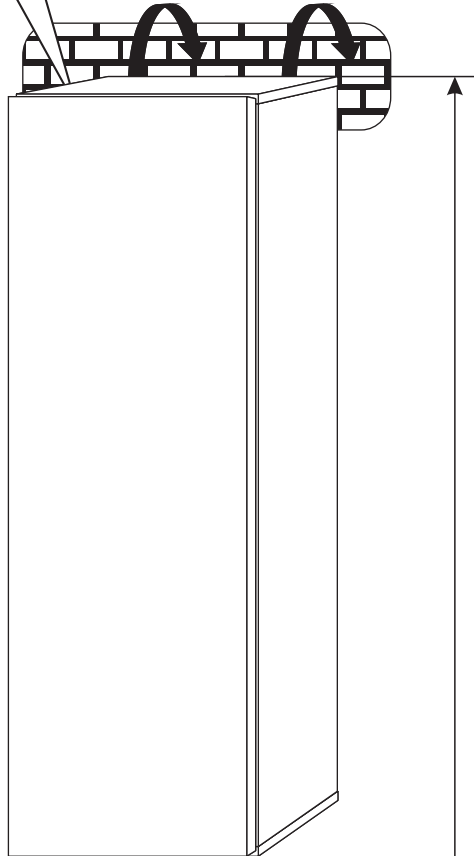
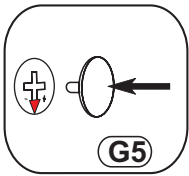
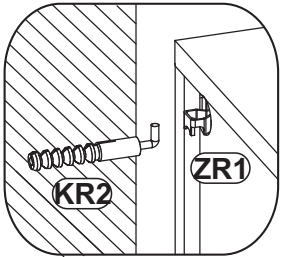

Instructions for hinge adjustment

- a) Side adjustment:
Loosen fixing screw "A", adjust gap with screw "B" and retighten screw "A".
- b) Depth adjustment:
Loosen fixing screw "A", push hinge arm forwards or backwards, retighten screw "A", fix screw "B" with a 1/4-turn in clock-wise direction.
- c) Height adjustment:
Loosen screw "C", adjust height, retighten screw "C".

Les possibilités de positionnement

- a) Positionnement de la rainure:
Desserrer la vis de fixation "A", positionner avec la vis "B" la rainure (joint) souhaitée et resserrer la vis "A".
- b) Positionnement de la profondeur:
Desserrer la vis de fixation "A" (1 tour), régler la profondeur et resserrer la vis "A".
- c) Positionnement de la hauteur:
Desserrer la vis de fixation "C" (1 tour), positionner la hauteur et resserrer la vis "C".